

DWG. NO.	SIZE	REV.	SR.
21F777 4	A	1	
DESCRIPTION		MATERIAL	MNT. LOCATION

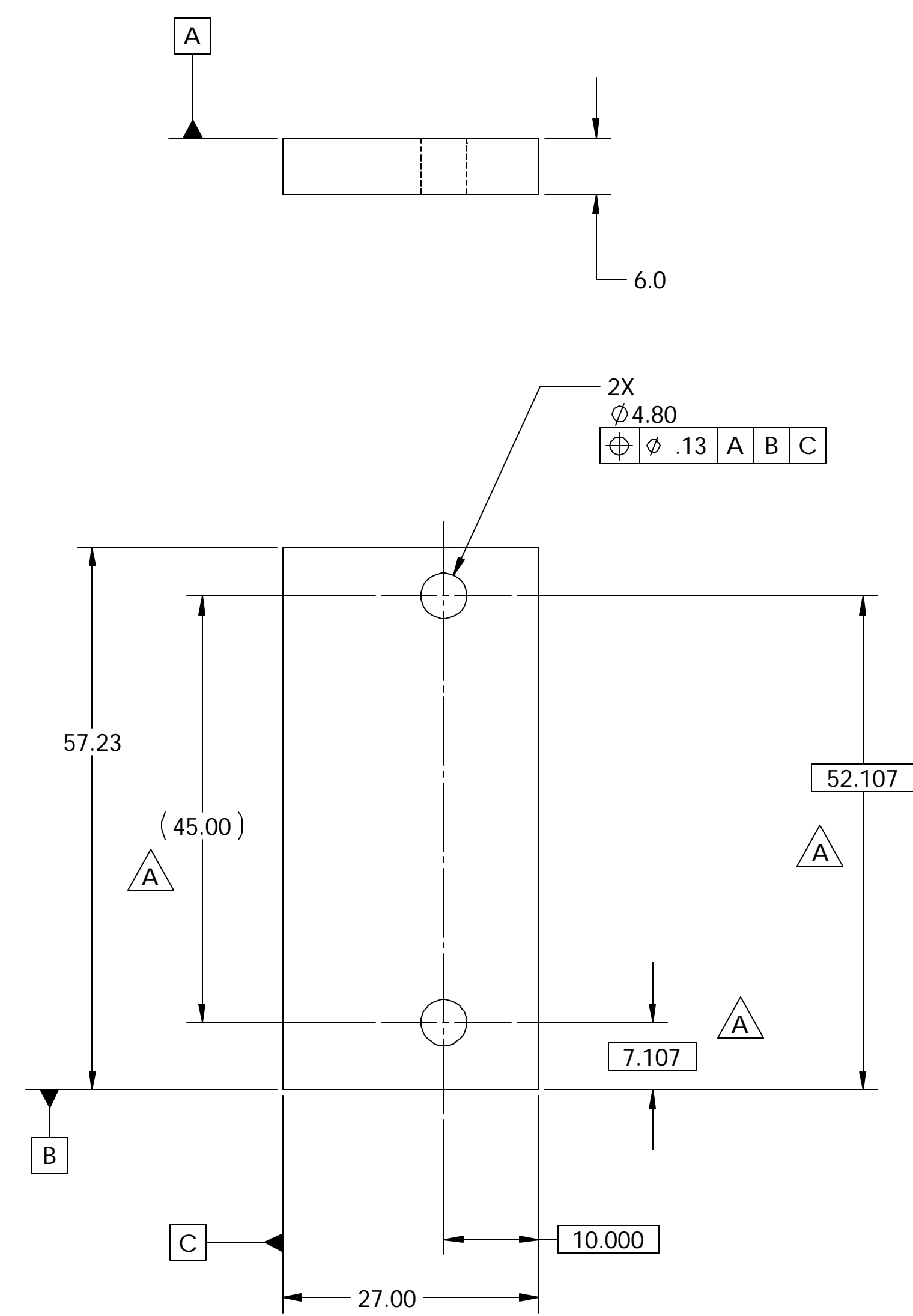

STIFFENER VERTEX PLATE CLAMP
MATL: ALUMINUM

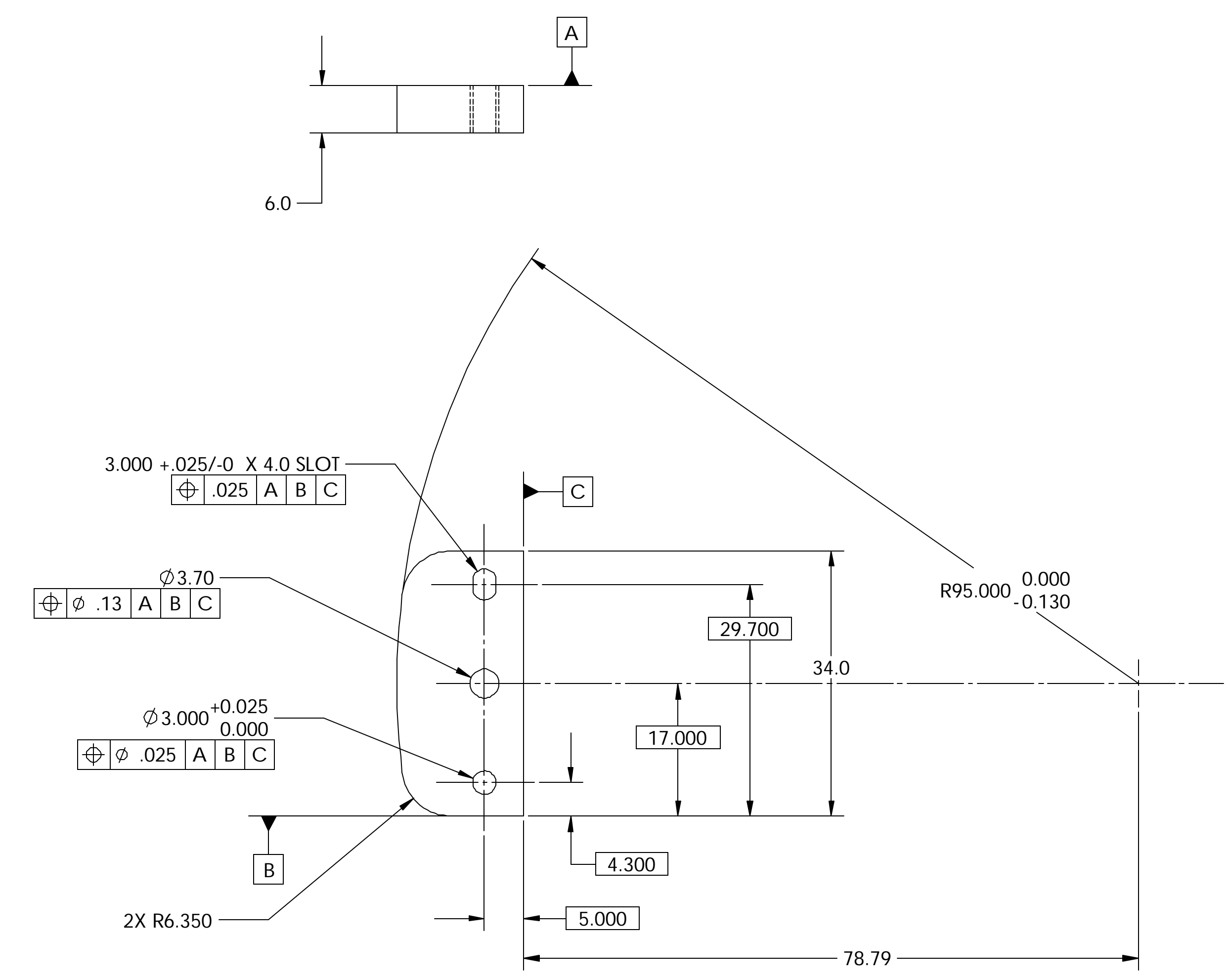

FACESHEET ALIGNMENT BLOCK
MATL: ALUMINUM

NOTES: UNLESS OTHERWISE SPECIFIED

- DIMENSIONS IN MILLIMETERS
- DIMENSIONS AND TOLERANCING PER ASME Y14.5M-1994
- SURFACE TEXTURE PER ANI/ASME B 46.1-1985
- REMOVE ALL BURRS AND BREAK SHARP EDGES TO A MAXIMUM OF .38
- ALL INSIDE CORNERS TO BE .38 RADIUS MAX
- COUNTERSINK 82 DEGREES ALL TAPPED HOLES TO MAJOR DIAMETER
- COUNTERSINK 82 DEGREES APPROXIMATELY .38 DEEP ALL DRILLED HOLES
- PARTS TO BE THOROUGHLY CLEANED TO REMOVE ALL OIL, GREASE, DIRT AND CHIPS

UNLESS OTHERWISE SPECIFIED		SHOP ORDERS		SER. NO.		ERNEST ORLANDO LAWRENCE	
TOLERANCES	X.X ± 0.5	FRAC. ± 1/64	ACCT. NO.	NO. REQD.	DATE ISSD	BERKELEY NATIONAL LABORATORY	
	X.XX ± 0.25	ANGLES ± 30°	DEL. TO	DATE REQD.	UNIVERSITY OF CALIFORNIA - BERKELEY #		
	X.XXX ± 0.013	FINISH 3.2	SURFACE TREATMENT		ATLAS PIXEL DETECTOR		
DO NOT SCALE PRINT			INDEX METHOD TAG		SPACEFRAME END STIFFENER		
THREADS ARE CLASS 2			PROJECT NUMBER		BONDING FIXTURE CLAMPS		
CHAMFER ENDS OF ALL SCREW THREADS 30°			PROJECT NAME		MICROFILMED:		
CUT ROUNDS, 1.5 THREAD RELIEF ON MACHINED THREADS			PROJECT US ATLAS SILICON SUBSYSTEM		DWG. TYPE		
BREAK EDGES .016 MAX. ON MACHINED WORK			DWE W. K. MILLER		DATE 4/16/2002		SHOWS ON
REMOVE BURRS, WELD SPLATTER & LOOSE SCALE			CHK BILL WILDS		DATE 4/16/2002		SCALE: 2:1
IN ACCORDANCE WITH ASME Y14.5m & B46.1			APR E ANDERSSSEN		DATE 4/16/2002		DO NOT SCALE PRINTS
REV	DWG	CHK	ZONE	DATE	CHANGES		PATENT CLEAR:
A	WKM	C6	9-3-02	REVISED CL HOLE LOCATIONS		DESIGN ACCT. NO.	SHOWS ON
						P1AP-11	SCALE: 2:1
						AP6250	DO NOT SCALE PRINTS

SHEET 1 OF 1

21F777 4 A